



Front Terminal Battery

6FM120F/12Volt 120Ah

Front Terminal Series Batteries are specially designed for telecom use with 12+ years design life in float service. By adopting a new AGM separator and centralised venting system, the battery can be installed in any position while maintaining high reliability.



General Features

- Heavy Duty Grid
- Mechanized assembly
- Non-spillable construction
- High Reliability and Stability
- Sealed and Maintenance-free
- Long Life and low self-discharge design

Construction

- Negative.....Lead
- Terminal.....Copper
- Positive.....Lead dioxide
- Electrolyte.....Sulfuric acid
- Separator.....Fiber glass
- Safety Valve.....EPDR
- Container.....ABS(UL94-HB) / (UL94-V0)

Specification

Battery Model	Nominal Voltage	12V			
	Rated capacity (10Hour rate)	200Ah			
	Cells Per battery	6			
Dimension	Length	Width	Height	Total Height	
	551mm	110mm	239mm	239mm	
Approx Weight	37.00Kg				
Internal Resistance	Full charged at 25°C (77°F): Approx 4.0mΩ				
Max. discharge current	960A(5s)				
Floating design life @ 25°C (77°F)	12 years				
Capacity @ 25°C (77°F)	10Hour rate(12.0A/10.8V)	5Hour rate(20.40A/10.5V)	3Hour rate(30.0A/10.5V)	1Hour rate(66.0A/10.5V)	
	120Ah	92Ah	72Ah	46Ah	
Capacity affected by Temp(10 HR)	40°C (104°F)	25°C (77°F)	0°C (32°F)	-15°C (5°F)	
	102%	100%	85%	65%	
Self Discharge @ 25°C (77°F)	After 3 months storage		After 6 months storage		After 12 months storage
	93%		84%		65%
Charge method @ 25°C (77°F)	Cycle Use		14.50-14.90V (Initial charging current less than 36.0A)		
	Float Use		13.60-13.80V		

Outer dimension (mm)

Terminal Type (mm)

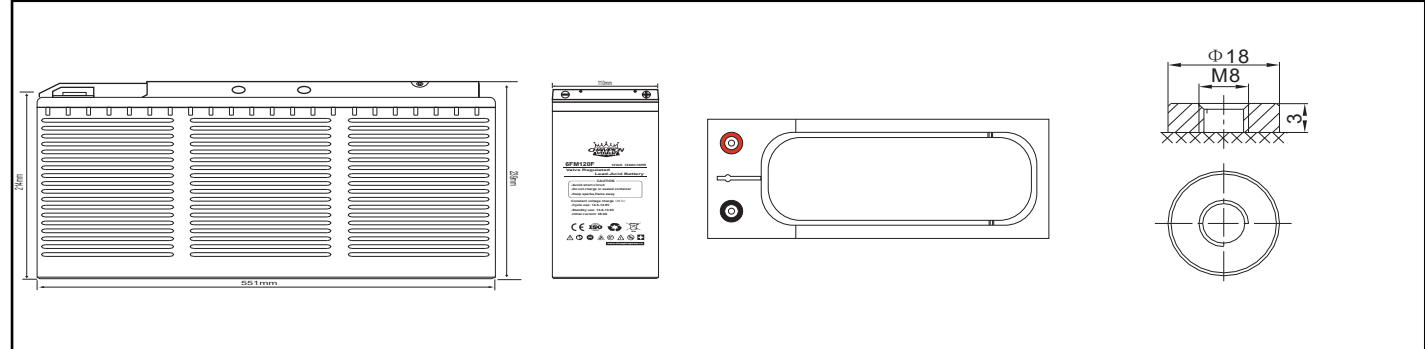

Constant Current(Amp) and Constant Power(Watt) Discharge Table at 25°C (77°F)

F.V / TIME		5min	10min	15min	30min	1h	2h	3h	4h	5h	8h	10h	20h
9.60V	A	432.00	264.00	210.00	138.00	72.60	42.00	31.20	25.20	21.05	13.90	13.20	6.84
	W	4579.20	2803.68	2247.00	1490.40	791.34	457.80	343.20	277.20	231.55	154.29	146.52	76.95
10.20V	A	396.00	253.20	193.00	131.00	72.00	40.30	30.60	24.00	20.65	13.68	12.60	6.72
	W	4316.40	2810.52	2151.95	1473.75	810.00	455.39	345.78	272.40	234.38	155.27	143.01	76.27
10.50V	A	367.25	241.99	180.00	127.00	69.60	39.50	30.00	22.80	20.40	13.50	12.36	6.64
	W	4039.75	2722.41	2034.00	1447.80	793.44	452.28	343.50	262.20	234.60	155.25	142.14	76.31
10.80V	A	334.40	239.90	168.00	121.20	68.40	38.50	29.40	22.40	19.50	13.15	12.00	6.55
	W	3678.40	2734.91	1923.60	1399.86	790.02	444.67	341.04	260.96	227.18	153.20	139.80	76.33
11.10V	A	289.20	228.00	156.00	112.80	66.00	37.50	28.20	22.00	18.65	12.80	11.70	6.48
	W	3267.96	2633.40	1809.60	1319.76	772.20	438.75	331.35	259.60	220.07	151.04	138.06	76.46

Note: The above datas are average values. (Edition 2017-11)

